

MODEL	HP/ FRAME	PUMP FLANGES (2)	
		SUCTION	DISCHARGE
MXM-22	0.5/56TC	1"	1"
	0.75/56TC		

REVISIONS			
REV	DESCRIPTION	DATE	APPROVED

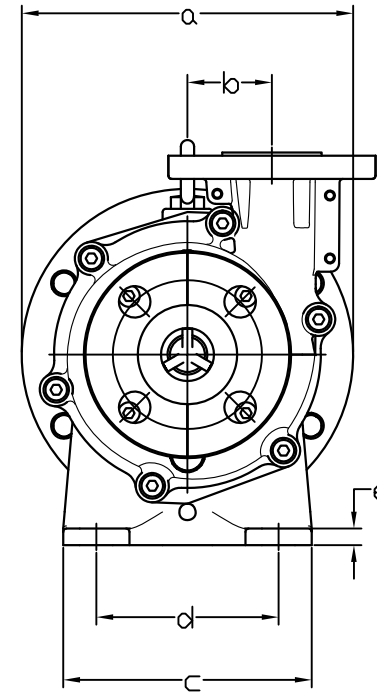
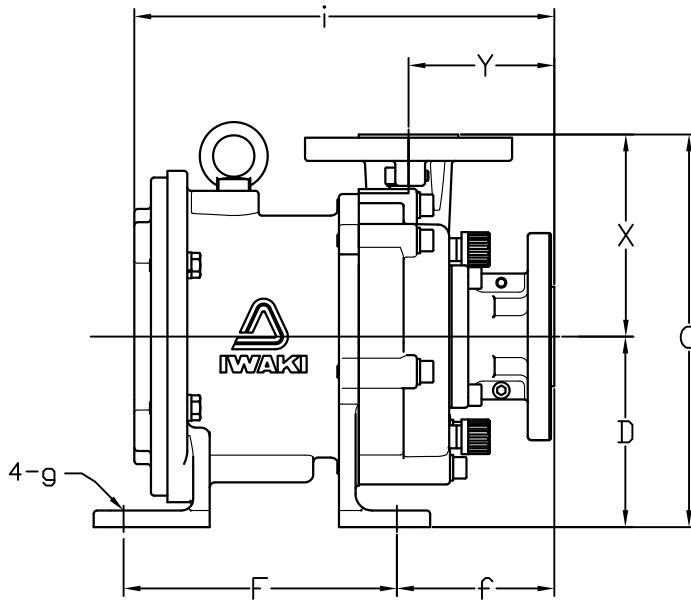

PUMP DIMENSIONS (1)												
a	b	c	d	D	e	f	F	g	i	□	X	Y
7.87	2.01	5.91	4.33	4.53	0.39	3.74	6.50	0.47	9.98	9.33	4.80	3.46

NOTES AND REFERENCES:

- (1) ALL DIMENSIONS IN INCHES. ALL TOLERANCES $\pm .125^\circ$, CONSULT IWAKI AMERICA FOR MORE DETAILS.
- (2) BOLT HOLE LOCATIONS OF SUCTION AND DISCHARGE FLANGES CONFORM TO ANSI B16.5 150 LB STANDARD.
- (3) DRAWN PER 2B404284.

PROPRIETARY THIS DRAWING CONTAINS CONFIDENTIAL INFORMATION PROPRIETARY TO IWAKI AMERICA. IT MUST NOT BE REPRODUCED OR FORWARDED TO OTHERS OR USED IN ANY OTHER WAY, IN WHOLE OR IN PART, UNLESS AUTHORIZED IN WRITING BY IWAKI AMERICA.		TOLERANCES DIMENSIONS IN INCHES (MM) UNLESS OTHERWISE NOTED X = .050 .XX = .010 .XXX = .005 DEBURR AND BREAK ALL SHARP EDGES		 IWAKI AMERICA www.IwakiAmerica.com		5 Boynton Rd. Hopping Brook Park Holliston, MA 01746 (508) 429-1440	
MATERIAL DUCTILE IRON		BY CJC	DATE 11/22/2011	SIZE A	DWG NO. IALT-00218	DESCRIPTION MXM-22 MAG DRIVE PUMP	REV A
APPROVED JTS	DATE 11/28/2011	SCALE: FULL	THIRD ANGLE PROJECTION	SHEET: 1 OF 1			